

MARS

2022. 4. 6. WED – 5. 1. SUN
GANA ART NINEONE#103 GANA ART, 91
Hannam-daero, youngsan-gu, Seoul 04401T. 82 2 795 5006 www.ganaart.com
info@ganaart.com

가나아트는 물, 바람, 불과 같은 자연의 원소를 작업의 소재로 활용하여 재료의 물성을 극대화하는 요리코 타카바타케(b.1982-)의 개인전 <<MARS>>를 개최한다. 이번 전시는 2019년에 선보인 <<Venus>> 이후 3년 만에 열리는 개인전으로, 작가는 이전과 같이 꾸준히 원초적인 힘에 의한 물감의 물리적인 변화를 실험한다. 작업 초기에도, 시각적인 재현보다는 작업을 통해 드러나는 '신체성'에 집중했던 타카바타케는 캔버스를 인간의 신체와 동일시하였다. 신체의 움직임으로 나타나는 노동 집약적 특성은 타카바타케의 작업에서 전반적으로 나타나는 특징이지만, 한편으로 그는 의도된 행위나, 지각적 환영에는 관심이 없다. 작가는 자연의 물리적인 힘을 가해 나타나는 우연한 물성의 변화를 기록하며 '관찰자'의 역할을 고수한다. 본 전시를 통해 공개되는 새로운 연작 <MARS>에선 철 가루와 자석을 활용했다. 이번 전시는 작가가 계속해서 시도하는 일본 모노파(もの派)와 한국 단색화 경향의 적절한 혼용뿐 아니라, 개입과 관조라는 양극성의 조화를 감상할 수 있는 흥미로운 자리가 될 것으로 기대한다.

Gana Art is pleased to present *MARS*, a solo exhibition of Yoriko Takabatake(b.1982-) who maximizes the physical properties of materials by using natural elements such as water, wind, and fire for her works. This exhibition has been held after her first exhibition *Venus* opened in South Korea 3 years ago, and Yoriko has constantly experimented with the physical change of paints on canvas by primitive power as before she did. In the early stages of her work, Yoriko focused on the 'physicality' of an artist revealed through the work rather than representation, identifying the canvas as the human body. The labor-intensive characteristics feature the overall Yoriko's works, but on the other hand, she has not been interested in the intended artificial act or the visual illusion. The artist has stuck to a belief, the role of the 'observer', by leaving the change of the physical properties that appear accidentally while adding the physical force of nature. The new series *MARS* which is exhibited in this exhibition is a new result of an experiment using the iron sand and the magnet. Thus, this exhibition will be an interesting show to appreciate the harmony of the bipolarity of intervention and contemplation as well as the proper mixing of Japanese Mono-ha and Korean monochromatic painting art tendencies that the artist steadily tries.



MARS, 2022, Oil, pigment on canvas
162 x 130 cm, 31.9 x 25.8 in.

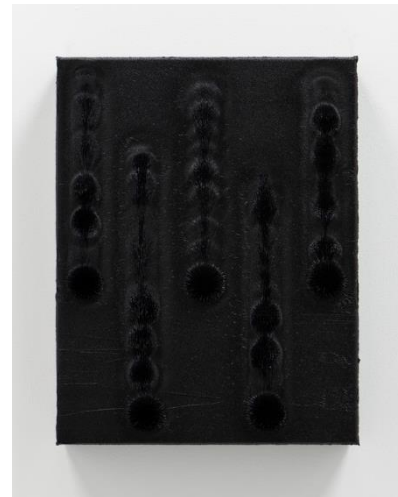

MARS, 2021, Oil, pigment, iron sand on canvas
41.5 x 32 cm, 16.3 x 12.6 in.

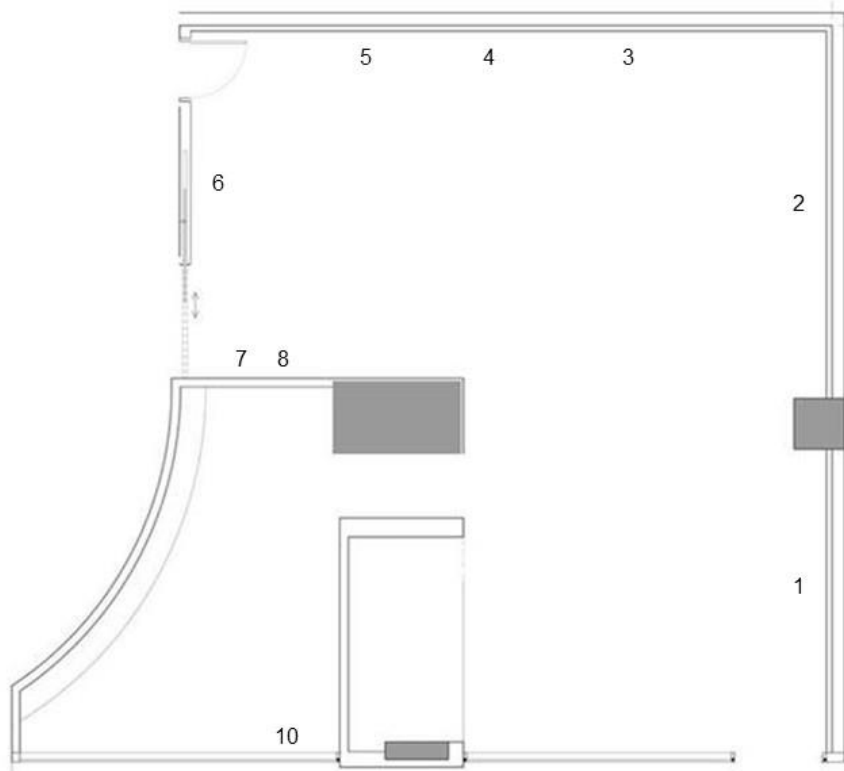

1. MARS, 2022, Oil, pigment on canvas, 162 x 130 cm, 31.9 x 25.8 in.
2. MARS, 2022, Oil, pigment on canvas, 162 x 130 cm, 31.9 x 25.8 in.
3. MARS, 2022, Oil, pigment, iron sand on canvas, 162 x 130 cm, 31.9 x 25.8 in.
4. MARS, 2022, Oil, pigment, iron sand on canvas, 162 x 130 cm, 31.9 x 25.8 in.
5. MARS, 2022, Oil, pigment, iron sand on canvas, 162 x 130 cm, 31.9 x 25.8 in.
6. MARS, 2021, Oil, pigment, iron sand on canvas, 162 x 130 cm, 31.9 x 25.8 in.
7. MARS, 2021, Oil, pigment, iron sand on canvas, 81 x 65.5 cm, 31.9 x 25.8 in.
8. MARS, 2022, Oil, pigment, iron sand on canvas, 81 x 65.5 cm, 31.9 x 25.8 in.
9. MARS, 2022, Oil, pigment, iron sand on canvas, 81 x 65.5 cm, 31.9 x 25.8 in.
10. MARS, 2022, Oil, pigment, iron sand on canvas, 41.5 x 32 cm, 16.3 x 12.6 in.